

# Fig. KISD16

## Ductile Iron Suction Diffuser

### PN16

#### Material Specifications

Description	Material
Body	Ductile Iron
Cover	Ductile Iron
Screen	Stainless Steel
O Ring	Rubber



#### Notes:

- Pressure Rating: PN16
- Temperature Rating: -10°C to 100°C
- Flanged ends to BS EN1092-2 PN16

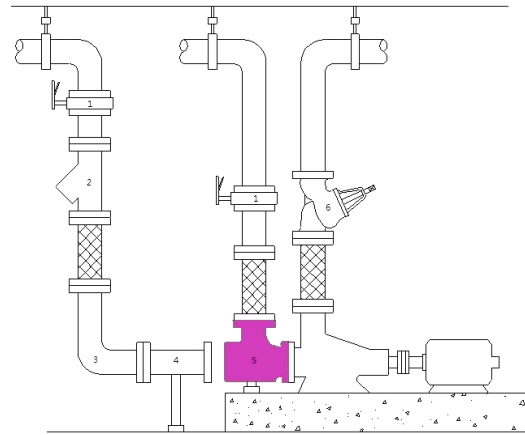
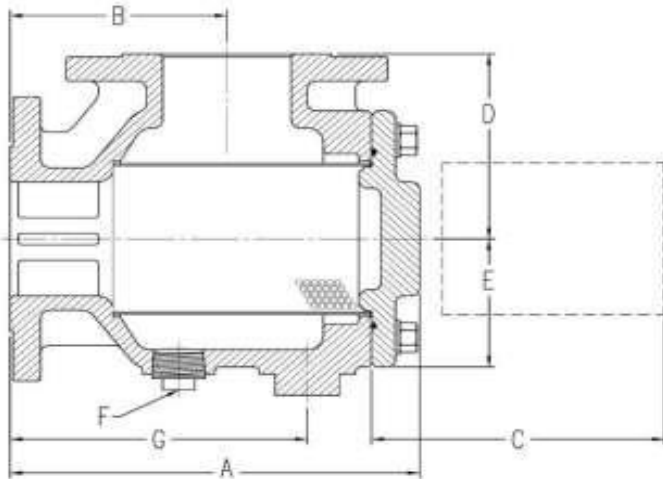

Size Code	Size	Inlet (mm)	Outlet (mm)	Strainer		Dimensions						
				Free open area (cm <sup>2</sup> )	Perforation (mm)	A	B	C	D	E	F	G
C	2x2	50	50	95	3.97	205	120	150	105	65	1/2"	155
D	2.5x2.5	65	65	220	3.97	220	125	150	115	80	1/2"	165
F	3x3	80	80	300	3.97	255	135	200	130	90	1"	185
G	4x3	100	80	300	3.97	255	135	200	130	90	1"	185
H	4x4	100	100	470	3.97	330	185	250	145	105	1"	240
I	5x4	125	100	470	3.97	330	185	250	145	105	1"	240
J	6x4	150	100	470	3.97	330	185	250	145	105	1"	240
K	5x5	125	125	730	3.97	400	230	300	180	120	1"	300
L	6x5	150	125	730	3.97	400	230	300	180	120	1"	300
AL	8x5	200	125	840	3.97	400	220	300	205	140	1"	275
M	6x6	150	150	840	3.97	400	220	300	210	140	1"	275
N	8x6	200	150	840	3.97	400	220	300	205	140	1"	275

# Fig. KISD16 Ductile Iron Suction Diffuser PN16

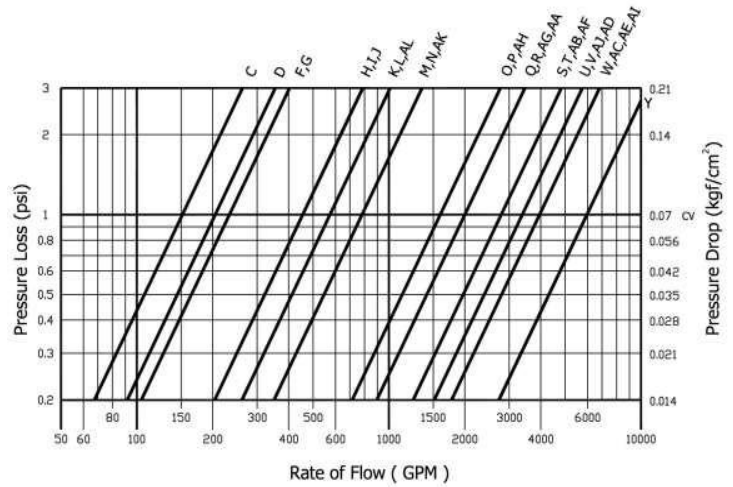
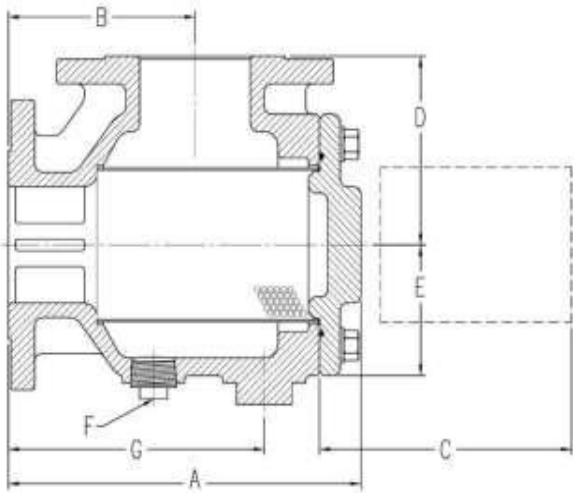

Size Code	Size	Inlet (mm)	Outlet (mm)	Strainer		Dimensions (mm)						
				Free open area (cm <sup>2</sup> )	Perforation (mm)	A	B	C	D	E	F	G
AK	10×6	250	150	1470	3.97	500	280	400	240	170	1"	370
O	8×8	200	200	1470	3.97	500	280	400	240	170	1"	370
P	10×8	250	200	1470	3.97	500	280	400	240	170	1"	370
AH	12×8	300	200	2270	3.97	625	325	500	280	190	1"	425
Q	10×10	250	250	2270	3.97	615	325	500	280	190	1"	425
R	12×10	300	250	2270	3.97	615	325	500	280	190	1"	425
AG	14×10	350	250	3000	3.97	690	380	550	305	240	1"	485
AA	16×10	400	250	3150	3.97	695	380	550	325	260	1"	480
S	12×12	300	300	3000	3.97	680	380	550	305	240	1"	485
T	14×12	350	300	3000	3.97	680	380	550	305	240	1"	485
AB	16×12	400	300	3150	3.97	705	380	550	325	260	1"	480
AF	18×12	450	300	3570	3.97	770	430	650	320	240	1"	480
U	14×14	350	350	4420	3.97	785	420	650	355	280	1"	550
V	16×14	400	350	4420	3.97	785	420	650	355	280	1"	550
AJ	18×14	450	350	4420	3.97	785	420	650	355	280	1"	550
AD	20×14	500	350	6320	3.97	1020	600	850	500	360	1"	750
W	16×16	400	400	4790	3.97	785	450	650	400	320	1"	550
AC	18×16	450	400	5100	3.97	825	450	700	400	320	1"	580
AE	20×16	500	400	6320	3.97	1020	600	850	500	360	1"	750
AI	22×16	550	400	6550	3.97	1050	600	900	500	360	1"	750
Y	20×20	500	500	8810	3.97	1070	650	900	500	400	1"	750